

# SPACE

Room sizes, seating capacities, & floor plans

## UPPER LEVEL

Meeting Space	Dim.	Square Feet	Ceiling Height	Theater	Classrm.	Banquet	U-Shape	10'x10' Booths*	8'x10' Booths*
<b>GRAND BALLROOM</b>									
All	181'x90'	16,200	22'-24'	1,577	816	1,050	-	94	107
Ballroom A	45'x90'	4,010	22'-24'	440	224	210	-	-	-
Ballroom B	45'x90'	4,010	22'-24'	440	224	220	-	-	-
Ballroom C	45'x90'	4,010	22'-24'	440	224	220	-	-	-
Ballroom D	45'x90'	4,170	22'-24'	440	224	220	-	-	-
Ballroom D1	30'x46'	1,390	22'-24'	144	84	80	40	-	-
Ballroom D2	30'x46'	1,410	22'-24'	144	84	80	40	-	-
Ballroom D3	30'x46'	1,370	22'-24'	144	76	80	40	-	-
<b>CONFERENCE ROOMS</b>									
Executive Board Room	42'x31'	1,270	12'x14'	<b>Conference Set for 22</b>		-	-	-	-
Conference Room	24'x21'	504	10'	<b>Conference Set for 18</b>		-	-	-	-

All capabilities are based on estimated square footage.

\*Booth capacities include prefunction space.

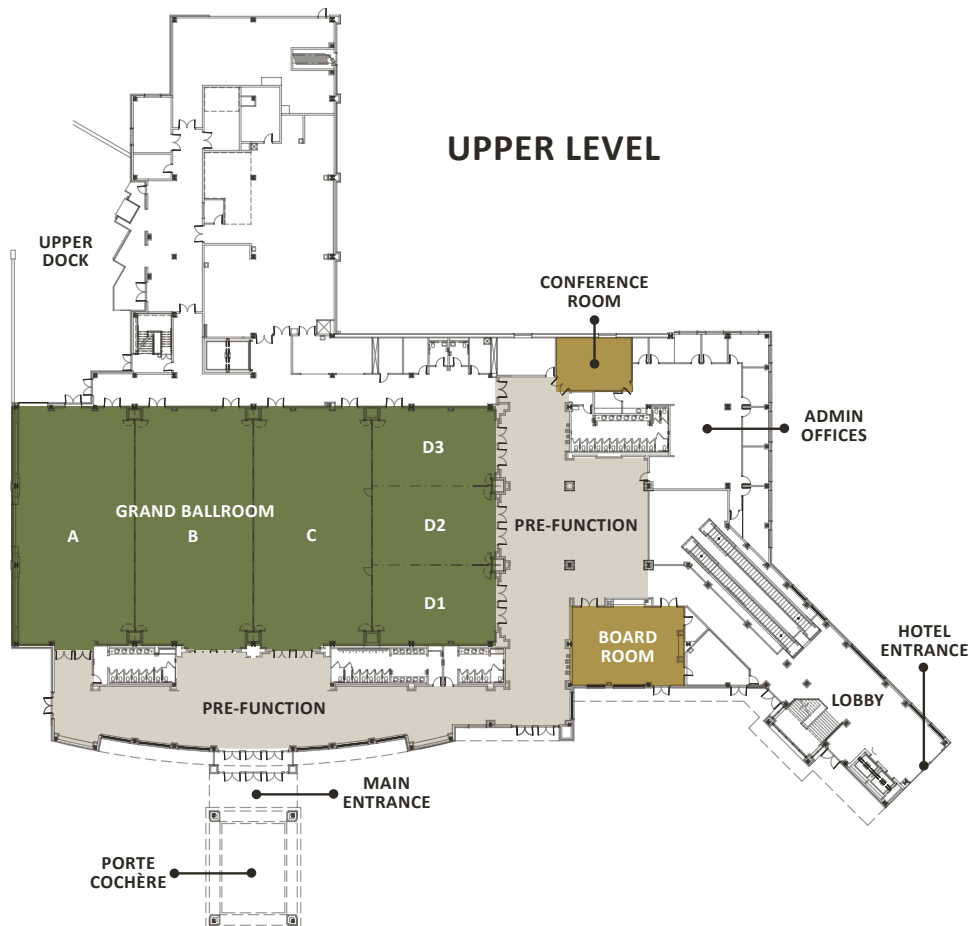

# LOWER LEVEL

Meeting Space	Dim.	Square Feet	Ceiling Height	Theater	Classrm.	Banquet	U-Shape	10'x10' Booths*	8'x10' Booths*
<b>EXHIBIT HALL</b>									
Expanded: North Hall + South Hall + Junior Ballroom	291'x125'	35,700	25'-30'	3,744	1,800	2,500	-	212	250
Combined: North Hall + South Hall	222'x125'	27,600	25'-30'	2,800	1,596	1,900	-	165	174
North Hall	118'x125'	14,500	25'-30'	1,500	760	1,000	-	71	86
South Hall	104'x125'	13,100	25'-30'	1,300	688	900	-	62	70
<b>JUNIOR BALLROOM</b>									
All	116'x50'	6,025	16'-18'	605	288	400	113	30	42
Jr. Ballroom A	50'x28'	1,450	16'-18'	156	96	80	43	-	-
Jr. Ballroom B	50'x30'	1,530	16'-18'	156	96	80	43	-	-
Jr. Ballroom C	50'x30'	1,530	16'-18'	156	96	80	43	-	-
Jr. Ballroom D	50'x29'	1,515	16'-18'	156	88	80	43	-	-
<b>MEETING ROOMS</b>									
Meeting Room 101	39'x28'	1,100	14'-15'	96	48	60	31	-	-
Meeting Room 102	34'x28'	1,000	14'-15'	84	40	40	29	-	-
Meeting Room 103	34'x28'	1,000	14'-15'	84	40	40	29	-	-
Meeting Room 104	29'x29'	840	12'	72	32	40	25	-	-
Meeting Room 105	46'x28'	1,310	12'	144	56	60	41	-	-
Pre-Function Room North	28'x18'	504	13'	48	24	Conference Style for 16		-	-
Pre-Function Room South	28'x18'	504	13'	48	24	Conference Style for 16		-	-

All capabilities are based on estimated square footage.

\*Booth capacities include prefunction space.



LOWER LEVEL